

SDR 11 ELECTROFUSION LONG COUPLER (IPS) DUAL RATED WATER/NATURAL GAS

Water - 240 PSI at 73 Deg F Sustainable
 Maximum Operating Pressure

Gas - 150 PSI at 73 Deg F Sustainable
 Maximum Operating Pressure

- Suitable for Water, Fluids & Slurry's
- Engineered for PE3408, PE4710 & PE100 HDPE Pipe Systems
- Manufactured in accordance with ASTM F-714,
 ASTM F-1055, ASTM D-2513
 ASTM D-3035, ASTM D-3261, ASTM D-3350,
 AWWA C-901, AWWA C-906
 DIN16963, EN1555, EN12201 ISO-9001 Certified

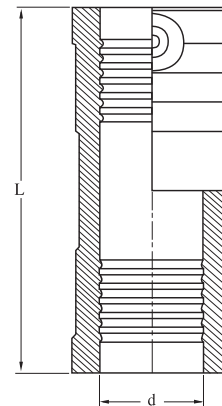

| Nominal Pipe Size (d) | Base Norm | L | Unit Weight in lbs. | Item Code |
|-----------------------|-----------|-------|---------------------|-------------------|
| 3/4" IPS | IPS | 4.25 | 1.43 | 30.MU1.00.11.0026 |
| 1" CTS | CTS | 5.04 | 0.26 | 30.MU1.55.11.0028 |
| 1" IPS | IPS | 5.04 | 0.26 | 30.MU1.55.11.0033 |
| 1 1/4" IPS | IPS | 6.38 | 0.33 | 30.MU1.55.11.0042 |
| 1 1/2" IPS | IPS | 6.38 | 0.61 | 30.MU1.55.11.0048 |
| 2" IPS | IPS | 7.32 | 1.13 | 30.MU1.55.11.0060 |
| 3" IPS | IPS | 10.04 | 2.94 | 30.MU1.55.11.0088 |
| 4" IPS | IPS | 11.93 | 5.28 | 30.MU1.55.11.0114 |